

NEW DISABLED TOILET- SHOWN GREEN

EXISTING TOILET BLOCK - SHOWN BLUE

NEW CHANGING PLACES AMENITIES - SHOWN YELLOW

NEW ACCESS PATHS

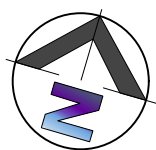
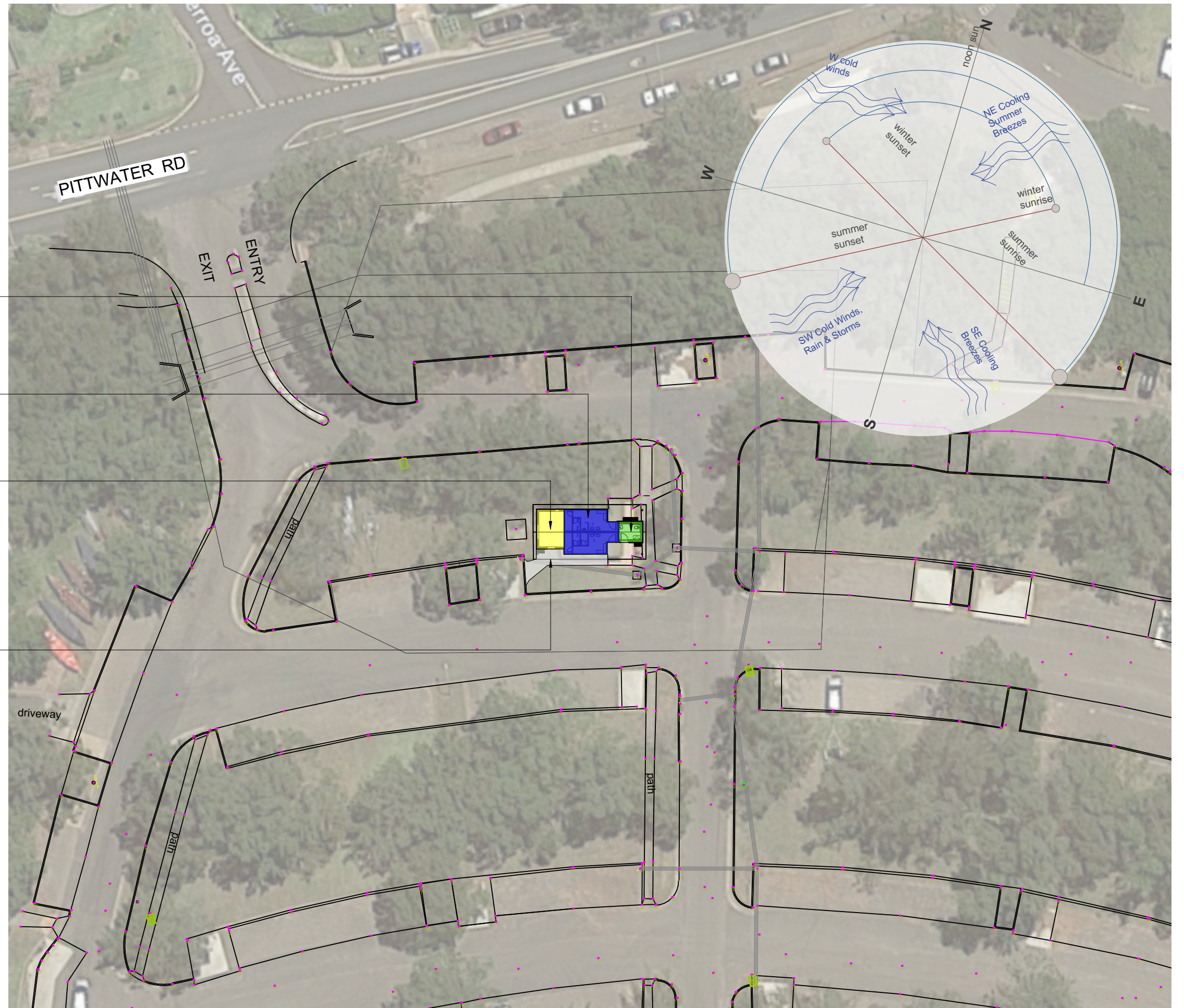

**WRAY AND CUTCLIFFE**  
ARCHITECTS  
e: jessica@wacarchitects.com.au • e: alice@wacarchitects.com.au  
m: 0421 755 086 m: 0424 561 309

\* This drawing and design are copyright and no portion may be reproduced without the written permission of Wray and Cutcliffe Architects Pty. Ltd. Locate & Protect all services prior to construction  
\* Use written dimensions or grid lines in preference to scaled dimensions. Measurements to existing work are to be checked on site. DO NOT SCALE FROM DRAWINGS.  
\* This drawing is to be read in conjunction with all relevant consultant reports, the Engineer's Drawings & Specification, Conditions of Contract and Accompanying Natspec Specification.  
\* Electronic data transfer should be scanned for viruses before use and any loss or damage (incl. consequential damage) caused to the recipient of electronic data, by its direct or indirect use, is not the liability of the designer or Wray and Cutcliffe Architects Pty. Ltd.  
\* All work in accordance to BCA - N.C.C. Australian Standards & all relevant authorities.  
\* Waterproof/ Weatherproofing Details to Master Builders Industry Guidelines and to meet performance standards as well as Australian Standards.

## Amenities Expansion

Context & Site Analysis Plan

TITLE

CLIENT

AT

Northern Beaches Council

Rowland Reserve Amenities Block

DATE 21/04/2023

SCALE as noted@A3

DRAWN JGW/SC

JOB NO. #2304

DWG

**SD-101**

ISSUE **A**

Issue	Description	Date
A	Schematic - Community Circulation	21/04/2023



e: jessica@wacarchitects.com.au • e: alice@wacarchitects.com.au  
m: 0421 755 086 m: 0424 561 309

- \* This drawing and design are copyright and no portion may be reproduced without the written permission of Wray and Cutcliffe Architects Pty. Ltd. Locate & Protect all services prior to construction
- \* Use written dimensions or grid lines in preference to scaled dimensions. Measurements to existing work are to be checked on site. DO NOT SCALE FROM DRAWINGS.
- \* This drawing is to be read in conjunction with all relevant consultant reports, the Engineer's Drawings & Specifications, Conditions of Contract and the relevant Code of Practice and Specifications.
- \* Electronic data transfer should be scanned for viruses before use and any loss or damage (incl. consequential damage) caused to the recipient of electronic data, by its direct or indirect use, is not the liability of the designer or Wray and Cutcliffe Architects Pty. Ltd.
- \* All relevant authorities.
- \* Waterproof/ Weatherproofing Details to Master Builders Industry Guidelines and to meet performance standards as well as Australian Standards.

### ***Amenities Expansion***

<b>TITLE</b>	Proposed Site Plan
<b>CLIENT</b>	Northern Beaches Council
<b>AT</b>	Rowland Reserve Amenities Block

DATE 21/04/2023  
SCALE as noted@A3  
DRAWN JGW/SC  
JOB NO. #2304

DWG  
SD-102  
ISSUE A

A	Schematic - Community Circulation	21/04/2023
<b>Issue</b>	<b>Description</b>	<b>Date</b>

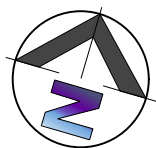
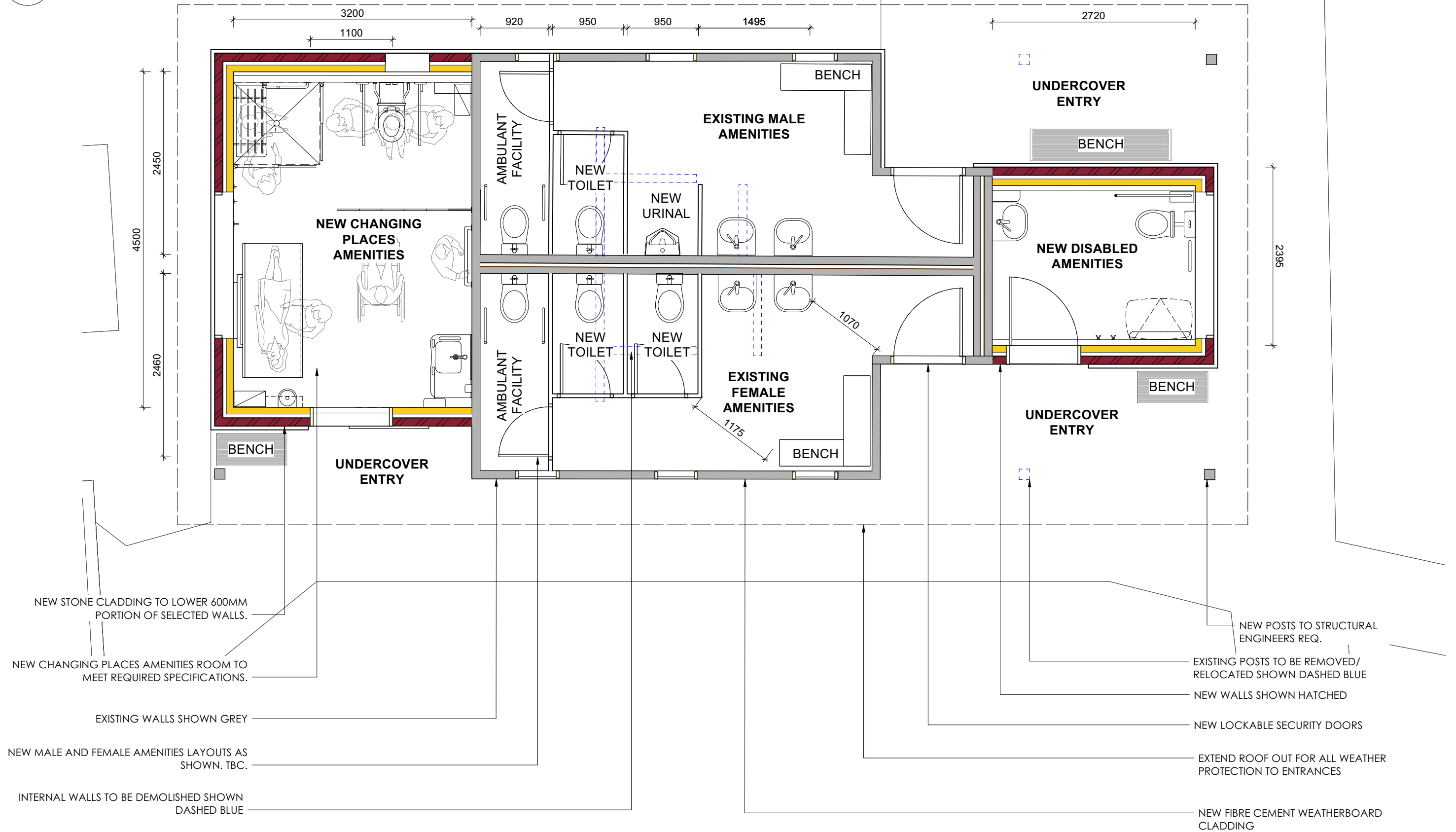

**WRAY AND CUTCLIFFE**  
ARCHITECTS

e: jessica@wacarchitects.com.au • e: alice@wacarchitects.com.au  
m: 0421 755 086 m: 0424 561 309

\* This drawing and design are copyright and no portion may be reproduced without the written permission of Wray and Cutcliffe Architects Pty. Ltd. Locate & Protect all services prior to construction  
\* Use written dimensions or grid lines in preference to scaled dimensions. Measurements to existing work are to be checked on site. DO NOT SCALE FROM DRAWINGS.  
\* This drawing is to be read in conjunction with all relevant consultant reports, the Engineer's Drawings & Specification, Conditions of Contract and Accompanying Natspec Specification.  
\* Electronic data transfer should be scanned for viruses before use and any loss or damage (incl. consequential damage) caused to the recipient of electronic data, by its direct or indirect use, is not the liability of the designer or Wray and Cutcliffe Architects Pty. Ltd.  
\* All work in accordance to BCA - N.C.C. Australian Standards & all relevant authorities.  
\* Waterproof/ Weatherproofing Details to Master Builders Industry Guidelines and to meet performance standards as well as Australian Standards.

## Amenities Expansion

Proposed Amenities Detail Plan

**TITLE**  
**CLIENT** Northern Beaches Council  
**AT** Rowland Reserve Amenities Block

**DATE** 21/04/2023  
**SCALE** as noted@A3  
**DRAWN** JGW/SC  
**JOB NO.** #2304

**DWG**  
**SD-103**  
**ISSUE A**

Issue	Description	Date
A	Schematic - Community Circulation	21/04/2023