

Freshwater Beach Masterplan Implementation

Artist's Impression



NewScape



SCAN FOR 360° VIEWS



The Freshwater Beach Masterplan project is highly anticipated by the community as it is the first major renewal of the site to be undertaken since the 1980s.

The challenge is to deliver a project that can respond to demand whilst enhancing the site's coastal context and preserving its much loved local character.

The current high level Masterplan was adopted by Northern Beaches Council (NBC) in May 2018. The decision to take the detailed concept design back to the community is an important one.

This next step allows Council to engage with the community and present in more detail the proposed design solutions to address general amenity, accessibility, play and maintenance requirements.

Once Council has heard from the community, we can prioritise what is most valued and work towards a staged implementation of those improvements.

Freshwater Beach Masterplan Implementation

Masterplan



northern
beaches
council

NewScape



KEY

1. Car park to remain
2. Seating areas
3. Grassed picnic areas with shelters, picnic tables and electrical bbqs
4. Picnic shelter
5. Accessible ramp
6. Shared way
7. Disabled car spaces
8. Dune vegetation protection fence

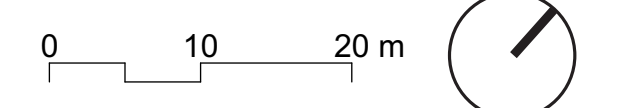

Freshwater Beach Masterplan Implementation

Playground Plan



NewScape



View A: Playground area



View B: Playground accessible spinner and shade sail view

KEY

- | | |
|--|---------------------------------------|
| 1. Retain existing water fountain | 8. Sandstone seating edge |
| 2. Fish cubby | 9. Repair and relocate existing bins |
| 3. Monkey bars | 10. Retain existing picnic shelter |
| 4. Platform table | 11. Somersault bars |
| 5. Incidental nature trail | 12. Climbing |
| 6. Accessible swing and shade sail (4xseats) | 13. Accessible spinner and shade sail |
| 7. Shipping rope tail - fixed to ground | 14. BBQ |

Freshwater Beach Masterplan Implementation

Accessible Ramp Plan



northern
beaches
council

NewScape



KEY

- 1. Pedestrian access along Moore Rd
- 2. Bike racks
- 3. Accessible ramp
- 4. Accessible pedestrian path (color canvas concrete pavement)
- 5. Timber seat
- 6. Double showers and sandstone wall
- 7. Picnic shelter



View A: Accessible ramp and stairs



View B: Parkland South with views towards accessible shared way

Freshwater Beach Masterplan Implementation

Lookout Plan



NewScape

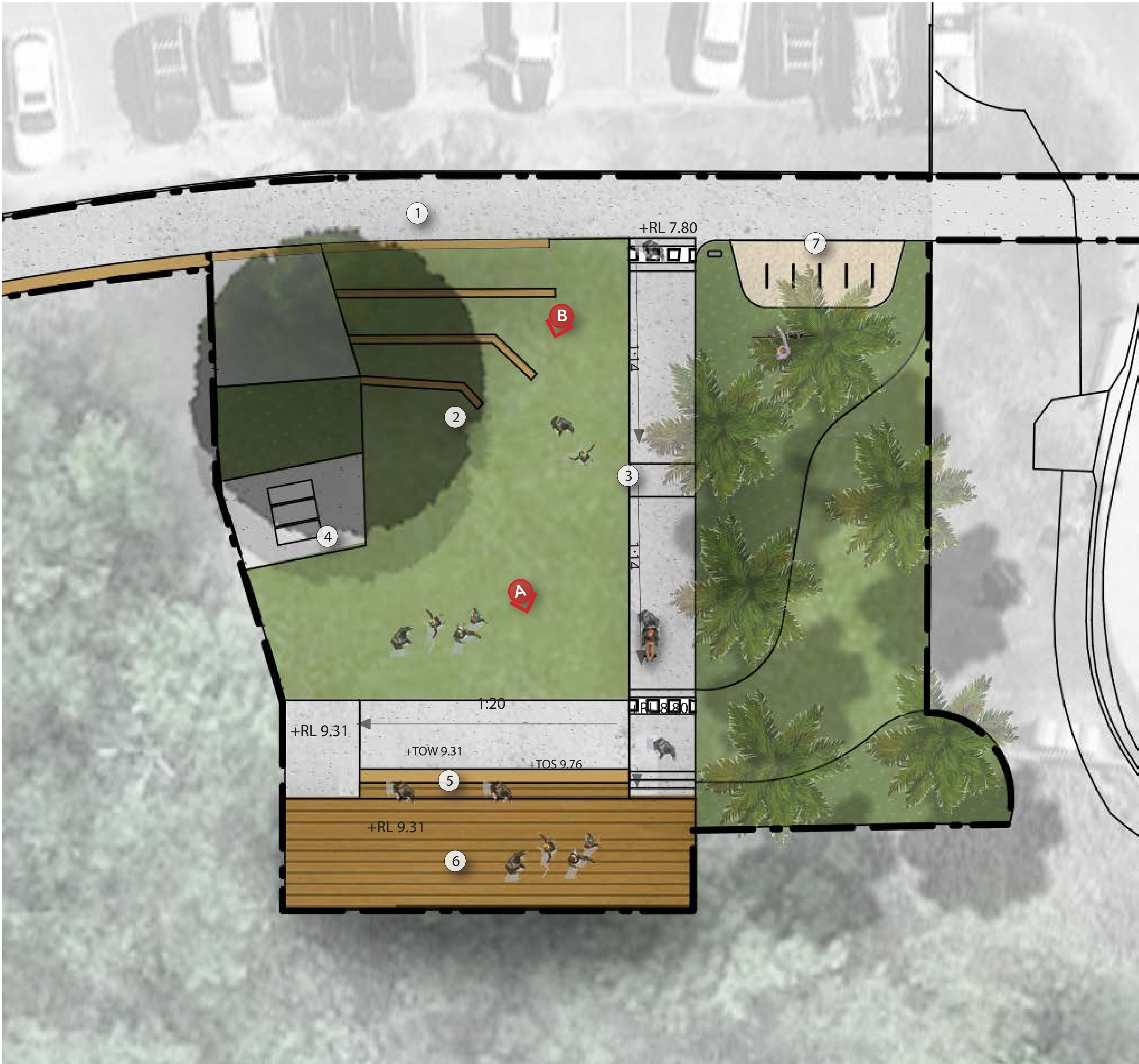

KEY

- 1. Kooloorra Ave to Ocean View Rd shared way
- 2. Existing steps to be retained
- 3. Accessible ramps to lookout
- 4. Picnic table
- 5. Lookout seating area
- 6. Elevated lookout
- 7. Bike racks



View A: Accessible walkway to lookout and terrace seating



View B: Lookout birdseye view

Freshwater Beach Masterplan Implementation

Artist's Impression



northern
beaches
council

NewScape



Freshwater Beach Masterplan Implementation

Masterplan Future Works and Stages



KEY

- 1. Access from Undercliff Rd
- 2. Moore Rd carpark
- 3. Zone for public art and artful play
- 4. Shared way access from Moore Rd
- 5. Accessible south ramp
- 6. Parkland shared way
- 7. Lifesaving Club green subject to future DA
- 8. Kooloora Ave carpark
- 9. Lookout

LEGEND

- FUTURE PROPOSED WORKS - PARK AMENITIES
- FUTURE WORKS - BUILDING PROPERTY WORKS ONLY
- FUTURE D&C WORKS OUTSIDE THIS SITE

