

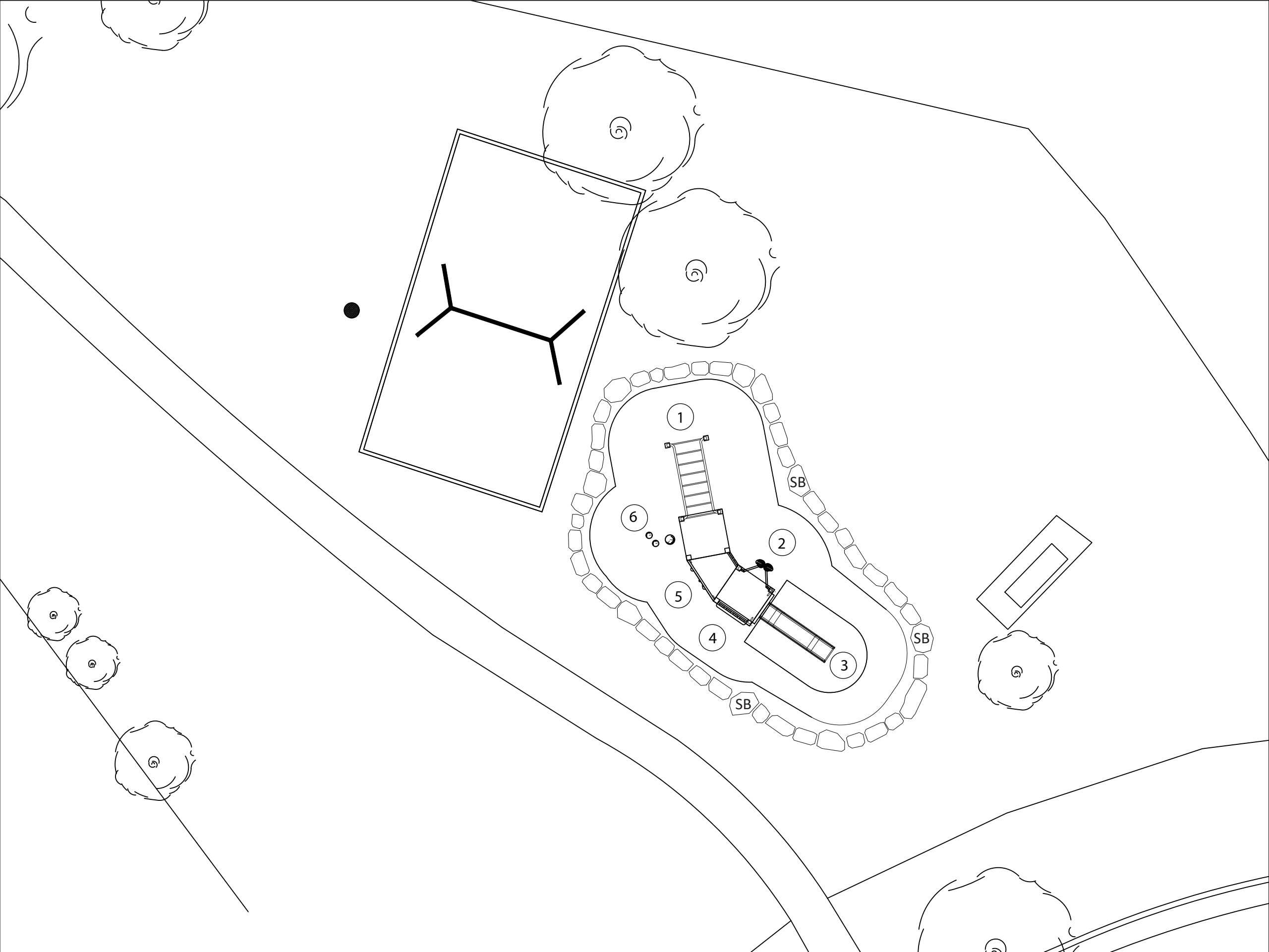



Allington Reserve  
Northern Beaches Council  
10th July 2023





- Custom Timber Play Structure**
1. MONKEY BARS
  2. LEAF STEPPER ACCESS
  3. 1200H SINGLE SLIDE
  4. SHOP FRONT PANEL
  5. ROCK CLIMBING WALL
  6. LOG STEPPER TRAIL

 Sandstone Edging

 1000x500x500 Sandstone Blocks

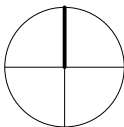

CLIENT AND JOB:  
**NORTHERN BEACHES COUNCIL**  
**ALLINGTON RESERVE**

DRAWN BY: AT

JOB NO:

DATE: 10/07/2023

SCALE: 1:100@A3

DRAWING NO.: PW-484

REVISION:



Play Workshop Pty Ltd  
PO Box 1004  
Lane Cove NSW 2066  
P: 02 9420 8296  
M: 0499 038 861  
E: russell@playworkshop.com.au  
W: www.playworkshop.com.au

# custom timber play structure

